

Code: TL-CPE510

ACCESS POINT **TL-CPE510** 5 GHz TP-LINK

Net: **59.13 EUR** Gross: **59.13 EUR**



Outdoor access point TL-CPE510 High Power 5 GHz is dedicated for WISPs (Wireless Internet Service Provider) to wireless data transmission. The device is equipped with a high gain antenna, which, together with the electronic board, is put in a weather-resistant housing.

Thanks to the antenna with 13 dBi gain, high output power of the transmitter equal 27 dBm and high sensitivity of the receiver, the device allows to create long-range, stable and efficient wireless connections. Device allows to secure data transmission using the encryption protocols: WEP, WPA/WPA2 and WPA-PSK/WPA2-PSK (64/128/152 bits).

SPECIFICATION

Frequency range:	5.15 GHz ... 5.85 GHz
Antenna type:	2Tx 2Rx MIMO
Gain :	13 dBi
Polarization:	vertical/horizontal
Standards:	IEEE 802.11a, IEEE 802.11n
Baud rates:	<ul style="list-style-type: none">• max. 300 Mbps @ 40 MHz (dynamic)• max. 144.4 Mbps @ 20 MHz (dynamic)• max. 72.2 Mbps @ 10 MHz (dynamic)• max. 36.1 Mbps @ 5 MHz (dynamic)
Receiver sensitivity:	<ul style="list-style-type: none">• IEEE 802.11a : 54 M : -75 dBm, 48 M : -76 dBm, 36 M : -83 dBm, 24 ... 6 M : -95 dBm• IEEE 802.11n : MCS15 : -73 dBm, MCS14 : -74 dBm, MCS13 : -76 dBm, MCS12 : -80 dBm, MCS11 : -83 dBm, MCS10 : -88 dBm, MCS9 : -90 dBm, MCS8 : -93 dBm, MCS7 : -73 dBm, MCS6 : -74 dBm, MCS5 : -76 dBm, MCS4 : -80 dBm, MCS3 : -83 dBm, MCS2 : -88 dBm, MCS1 : -90 dBm, MCS0 : -93 dBm
Operation modes:	AP, Client, Repeater, AP router, WISP
Protections:	WEP 64/128/152-bit, WPA/WPA2, WPA-PSK/WPA2-PSK
LAN ports:	1 x 10/100Mb LAN + PoE, Shielded
Management interface:	Web browser, PharOS Control application
Transmitter power:	max. 26 dBm
Horizontal beam width (H):	45 °
Vertical beam width (V):	45 °

DELTA-OPTI Monika Matysiak; <https://www.delta.poznan.pl>
POL; 60-713 Poznań; Graniczna 10
e-mail: delta-opti@delta.poznan.pl; tel: +(48) 61 864 69 60

Housing:	Outdoor, plastic (Weatherproof) - IPX5
Overvoltage protection:	<ul style="list-style-type: none"> • 15 kV ESD • 6 kV lightning
Power supply PoE:	✓ (up to 60 m via UTP cable)
Power supply:	24 V / 1 A Passive PoE (power adapter included)
Power consumption:	12 W
Operation temp:	-30 °C ... 70 °C
Permissible relative humidity:	10 % ... 90 %
Memory:	64MB DDR2, 8MB Flash
Processor:	Qualcomm 560MHz, MIPS 74Kc
Main features:	<ul style="list-style-type: none"> • MIMO technology - increases the throughput of wireless link (multiple antennas transmission) • Adjustable transmission power • TP-LINK Pharos MAXstream TDMA Technology • Transmission range even up to 15 km • PharOS Control Central Management System • Support for tools Antenna Alignment, Distance Setting, Ping Watch Dog and Wireless Speed Test • Wireless signal quality indicators • Bandwidth : 5, 10, 20, 40 MHz • Multi-SSID • WDS • MAC addresses filtering • SSID hiding • DDNS • SSH • Watchdog built-in • RESET button
Weight:	0.32 kg
Dimensions:	224 x 79 x 60 mm
Manufacturer / Brand:	TP-LINK
Guarantee:	3 years

PRESENTATION

Mounting side view:



Signal indicator:



Connectors view:



PoE Power Supply and Adapter:







In the kit:



Transmission schematic diagram:

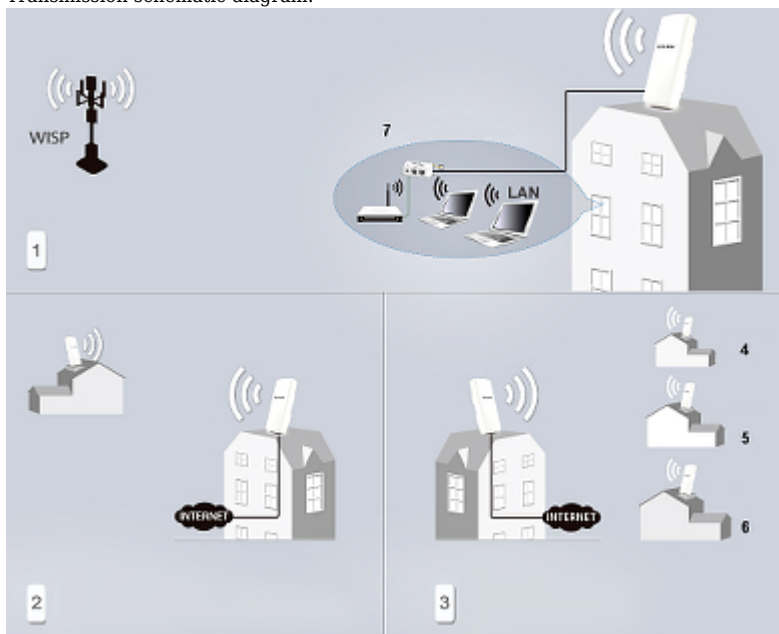

- 1. WISP client
- 2. Point-to-Point connection
- 3. Connection point-to-multipoint
- 4. 1 client
- 5. 2 client
- 6. 3 client
- 7. Local Area Network

PACKAGE

Dimensions (L x W x H): 0x0x0 mm	Gross Weight: 0 kg
----------------------------------	--------------------