

Code: DRC-12V30W-1AZ

SWITCHING ADAPTER **DRC-12V30W-1AZ** Delta Electronics

Net: **25.18 EUR** Gross: **25.18 EUR**

Switching adapter installed on the TS35/7.5 or 15 DIN rail, resistant to high operation temperatures (up to 70°C).



SPECIFICATION

Adapter type:	Switching
Power voltage:	90 ... 264 V AC
Output voltage:	12 V DC
Output voltage adjustment:	11.5 ... 14.5 V
Maximal load:	2.1 A
Output power:	30 W
Number of outputs:	2 pcs
Efficiency:	> 85 %
Housing type:	DIN
Vibration resistance:	✓
Protections:	<ul style="list-style-type: none">• Short-circuit• Overload• Overvoltage
Operation temp. / Relative humidity:	-25 °C ... 71 °C / 5 ... 95 %
Weight:	0.14 kg
Dimensions:	53 x 91 x 56 mm
Manufacturer / Brand:	Delta Electronics
Guarantee:	5 years

PRESENTATION

Front view:



DELTA-OPTI Monika Matysiak; <https://www.delta.poznan.pl>
POL; 60-713 Poznań; Graniczna 10
e-mail: delta-opti@delta.poznan.pl; tel: +(48) 61 864 69 60



Adapter connectors:



Rear panel (DIN rail installation):



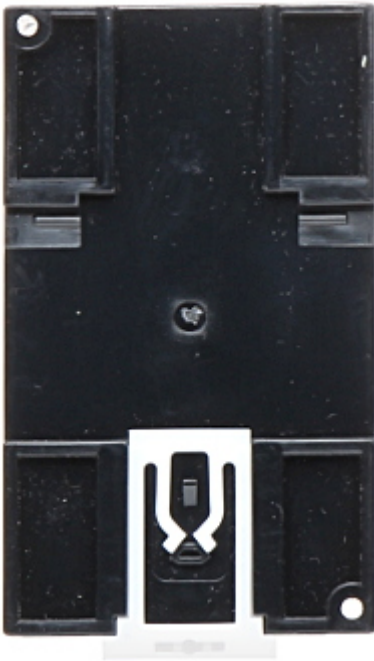

Dimensions:

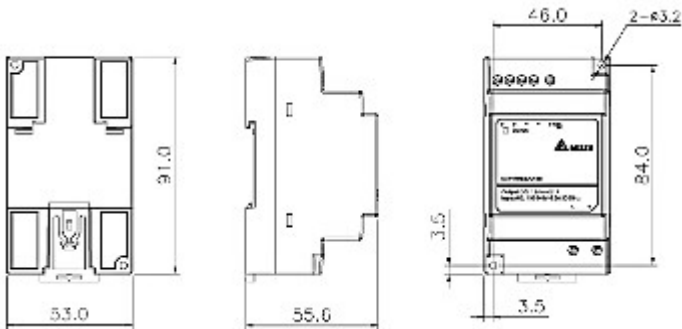

PACKAGE

Dimensions (L x W x H): 0x0x0 mm	Gross Weight: 0 kg
----------------------------------	--------------------

