

Code: TL-CPE210

ACCESS POINT **TL-CPE210** 2.4 GHz TP-LINK

Net: **37.95 EUR** Gross: **46.68 EUR**



Outdoor access point TL-CPE210 High Power 2.4 GHz is dedicated for WISPs (Wireless Internet Service Provider) to wireless data transmission. The device is equipped with a high gain antenna, which, together with the electronic board, is put in a weather-resistant housing.

Thanks to the antenna with 9 dBi gain, high output power of the transmitter equal 27 dBm and high sensitivity of the receiver, the device allows to create long-range, stable and efficient wireless connections. Device allows to secure data transmission using the encryption protocols: WEP, WPA/WPA2 and WPA-PSK/WPA2-PSK (64/128/152 bits).

SPECIFICATION

Frequency range:	2.4 GHz ... 2.483 GHz
Antenna type:	2Tx 2Rx MIMO 9 dBi Integrated
Polarization:	vertical/horizontal
Standards:	IEEE 802.11b, IEEE 802.11g, IEEE 802.11n
Baud rates:	<ul style="list-style-type: none">• max. 300 Mbps @ 40 MHz (dynamic)• max. 144.4 Mbps @ 20 MHz (dynamic)• max. 72.2 Mbps @ 10 MHz (dynamic)• max. 36.1 Mbps @ 5 MHz (dynamic)
Receiver sensitivity:	<ul style="list-style-type: none">• IEEE 802.11b : 11 M : -95 dBm, 5.5 M : 96 dBm, 2 M : 96 dBm, 1 M : 96 dBm• IEEE 802.11g : 54 M : -79 dBm, 48 M : -80 dBm, 36 M : -84 dBm, 24 ... 6 M : -88 dBm• IEEE 802.11n : MCS15 : -76 dBm, MCS14 : -78 dBm, MCS13 : -80 dBm, MCS12 : -84 dBm, MCS11 : -87 dBm, MCS10 : -91 dBm, MCS9 : -93 dBm, MCS8 : -96 dBm, MCS7 : -76 dBm, MCS6 : -78 dBm, MCS5 : -80 dBm, MCS4 : -84 dBm, MCS3 : -87 dBm, MCS2 : -91 dBm, MCS1 : -93 dBm, MCS0 : -96 dBm
Operation modes:	AP, Client, Repeater, AP router, WISP
Protections:	WEP 64/128/152-bit, WPA/WPA2, WPA-PSK/WPA2-PSK
LAN ports:	<ul style="list-style-type: none">• 1 x 10/100Mb LAN 0 + PoE, Shielded• 1 x 10/100Mb LAN 1 + PoE Passthrough, Shielded
Management interface:	Web browser, PharOS Control application
Transmitter power:	max. 27 dBm
Horizontal beam width (H):	65 °
Vertical beam width (V):	35 °

DELTA-OPTI Monika Matysiak; <https://www.delta.poznan.pl>
POL; 60-713 Poznań; Graniczna 10
e-mail: delta-opti@delta.poznan.pl; tel: +(48) 61 864 69 60

Housing:	Outdoor, plastic (Weatherproof) - IPX5
Overvoltage protection:	<ul style="list-style-type: none"> • 15 kV ESD • 6 kV lightning
Power supply PoE:	✓ (up to 60 m via UTP cable)
Power supply:	24 V / 1 A Passive PoE (power adapter included)
Operation temp:	-30 °C ... 70 °C
Permissible relative humidity:	10 % ... 90 %
Main features:	<ul style="list-style-type: none"> • MIMO technology - increases the throughput of wireless link (multiple antennas transmission) • Adjustable transmission power • TP-LINK Pharos MAXtream TDMA Technology • Transmission range even up to 5 km • PharOS Control Central Management System • Support for tools Antenna Alignment, Distance Setting, Ping Watch Dog and Wireless Speed Test • Wireless signal quality indicators • Bandwidth : 5, 10, 20, 40 MHz • Multi-SSID • WDS • MAC addresses filtering • SSID hiding • DDNS • SSH • Watchdog built-in • RESET button
Weight:	0.338 kg
Dimensions:	224 x 79 x 60 mm
Manufacturer / Brand:	TP-LINK
Guarantee:	3 years

PRESENTATION

Mounting side view:



Signal indicator:



connector:



PoE Power Supply and Adapter:





In the kit:



Transmission schematic diagram:

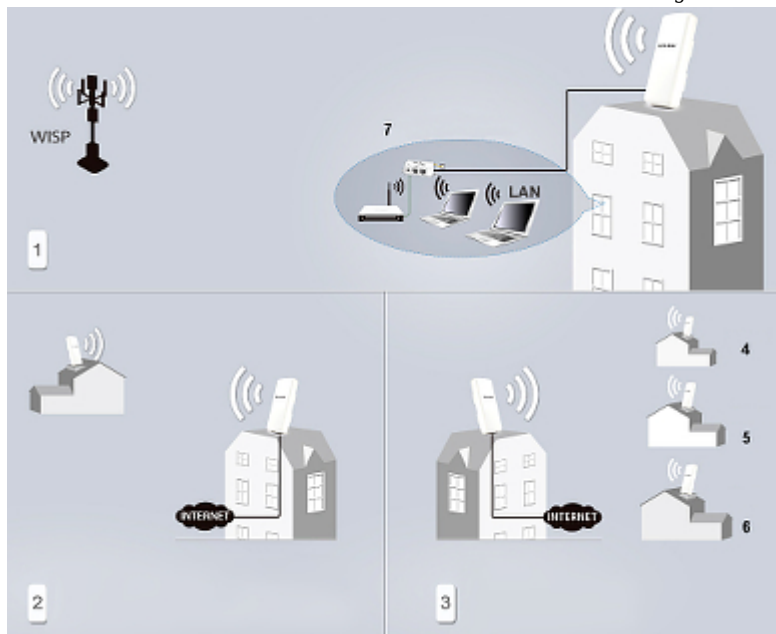

1. WISP client
2. Point-to-Point connection
3. Connection point-to-multipoint
4. 1 client
5. 2 client
6. 3 client
7. Local Area Network

