

Code: PFM881

## ACCESS POINT **PFM881** DAHUA

Net: **203.25 EUR** Gross: **250.00 EUR**



The PFM881 is an integrated solution for professional outdoor wireless networks. Thanks to a unique construction, device offers unparalleled performance in such a compact device.

The casing made of UV resistant plastic is resistant to even the most severe weather conditions.

### SPECIFICATION

Frequency range:	5470 MHz ... 5825 MHz
Antenna type:	15 dBi Integrated, 2Tx 2Rx MIMO
Standards:	802.11 a/n
Baud rates:	max. 300 Mbps
Wireless transmission range:	max. 5 km
LAN ports:	2 x 10/100 Mbps BASE-TX (Cat. 5, RJ-45)
Vertical beam width (V):	15 °
Horizontal beam width (H):	40 °
Operation modes:	Client, WDS client, Access Point, Access Point WDS, Repeater
Protections:	15kV surge protection of radio line
Transmitter power:	23 dBm
Receiver sensitivity:	<ul style="list-style-type: none"><li>• -74 dBm @ 65 Mbps</li><li>• -96 dBm @ 1 Mbps</li></ul>
Processor:	Atheros AR7240, 400 MHz
Port USB:	—
Power supply PoE:	✓
Power supply:	24 V / 0.5 A PoE (power adapter included)
Power consumption:	8 W

DELTA-OPTI Monika Matysiak; <https://www.delta.poznan.pl>  
POL; 60-713 Poznań; Graniczna 10  
e-mail: [delta-opti@delta.poznan.pl](mailto:delta-opti@delta.poznan.pl); tel: +(48) 61 864 69 60

Operation temp:	-30 °C ... 70 °C
Permissible relative humidity:	5 % ... 95 %
Weight:	0.3 kg
Dimensions:	270 x 83 x 50 mm
Manufacturer / Brand:	DAHUA
Guarantee:	<b>3 years</b>

## PRESENTATION

Front view:



Rear view:



Side view:



Bottom view (after remove the cover):

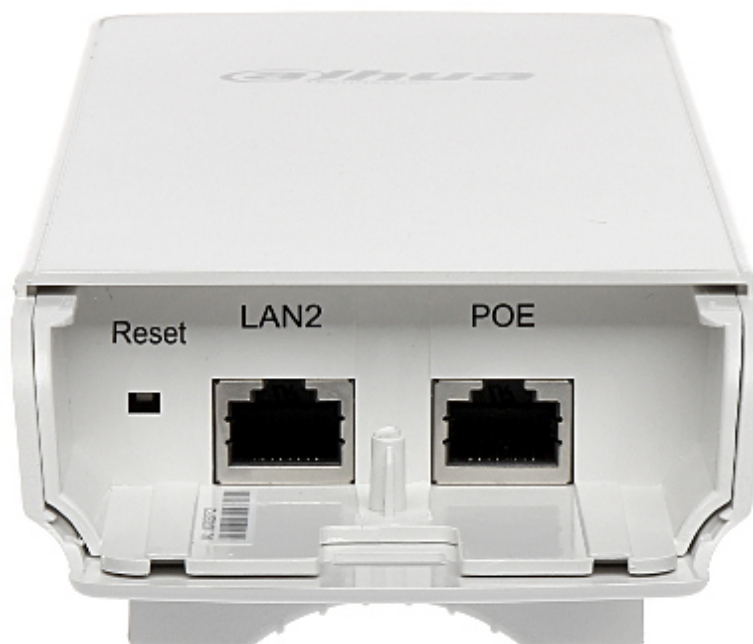

Examples of connection diagrams:

Schematic diagram for point-multipoint configuration:

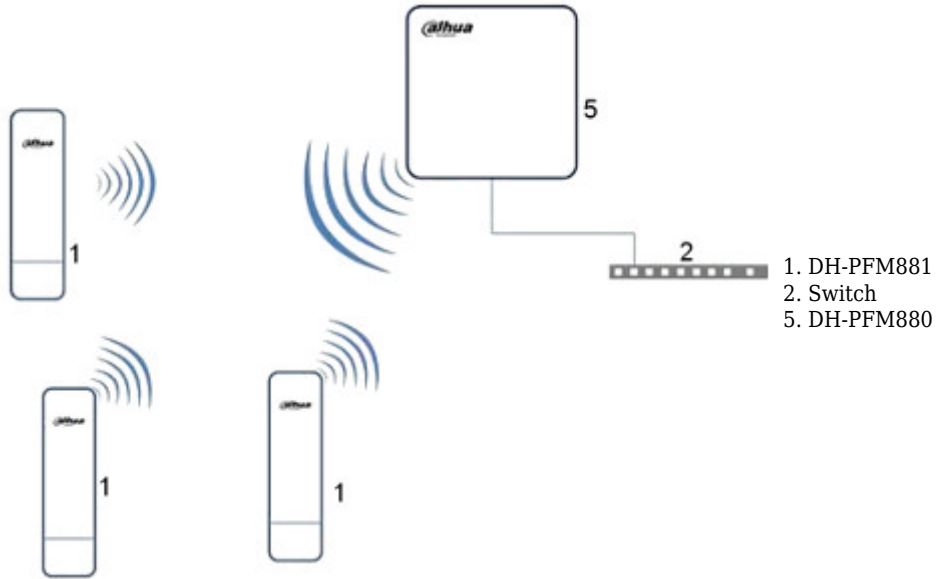

Schematic diagram for point-point configuration:

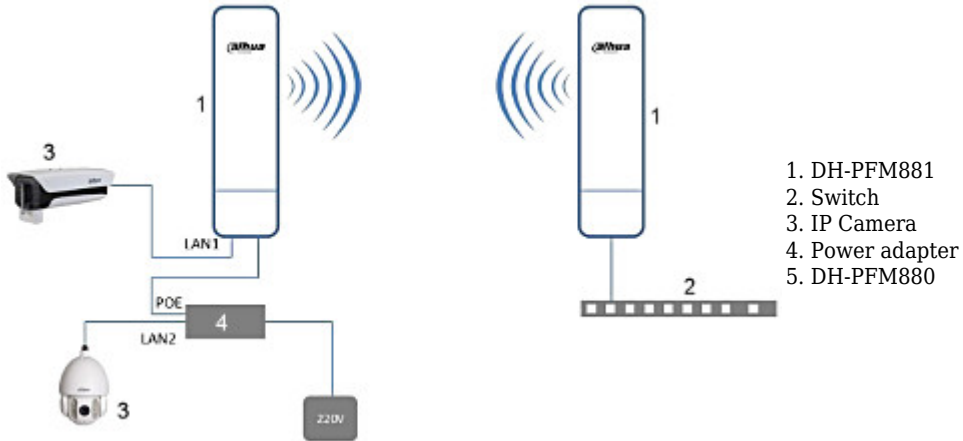

Back-to-Back connection schematic diagram:

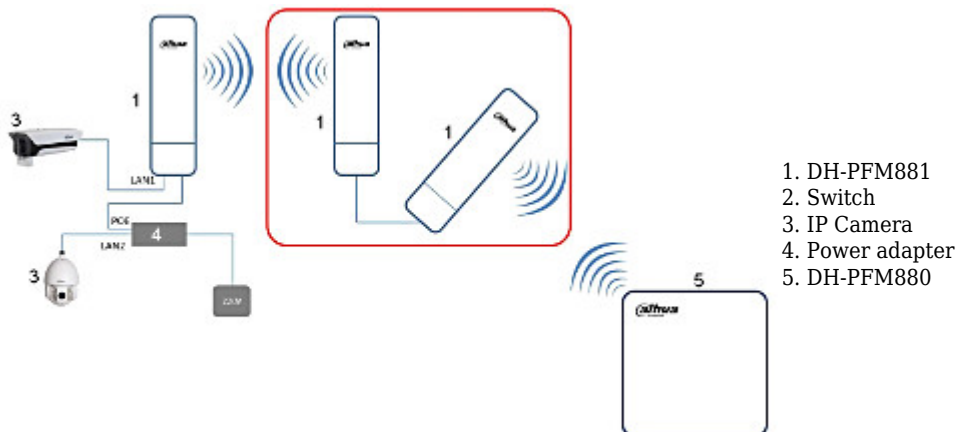

In the kit:

