

Code: AQUA-LUNA

PIR DETECTOR **AQUA-LUNA** SATEL

Net: **13.79 EUR** Gross: **16.96 EUR**

Digital passive PIR detector with remotely controlled built-in LED emergency lighting. To control the detector LED lighting is used the output of the alarm control panel preprogrammed as desired.



SPECIFICATION

Application:	Indoor
Pyroelectric sensor:	Double
Sensor type:	Passive Infra Red (PIR)
Range:	15 x 14 m
Sensitivity adjustment:	3-step
Prealarm feature:	✓
Alarm time:	2 s
Maximal outputs load:	40 mA / 16 V DC
Digital temperature compensation:	✓
Pet immunity:	—
Power supply:	12 V DC / 12 mA
Operation temp:	-10 °C ... 55 °C
Target speed range:	0.3 ... 3 m/s
Main features:	<ul style="list-style-type: none">• Remote control of the LED emergency lighting• Max. current consumption by LED lighting 28 mA
Weight:	0.072 kg
Dimensions:	63 x 96 x 49 mm
Manufacturer / Brand:	SATEL

DELTA-OPTI Monika Matysiak; <https://www.delta.poznan.pl>
POL; 60-713 Poznań; Graniczna 10
e-mail: delta-opti@delta.poznan.pl; tel: +(48) 61 864 69 60

Guarantee:

2 years

PRESENTATION

Internal view:

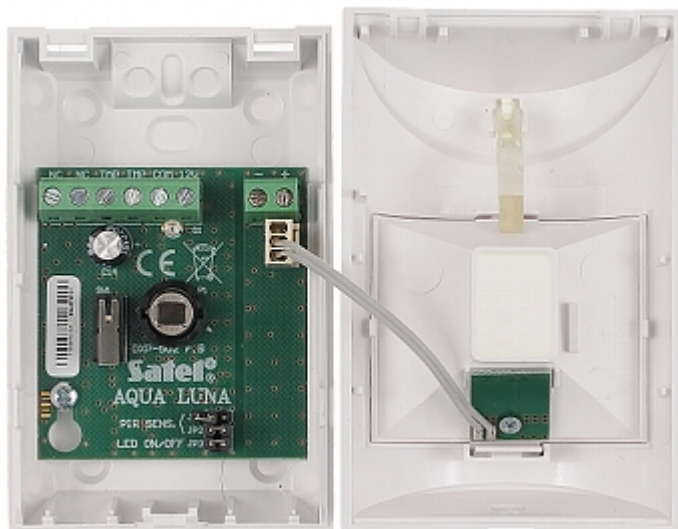

In the kit:



Description of particular elements of the device:

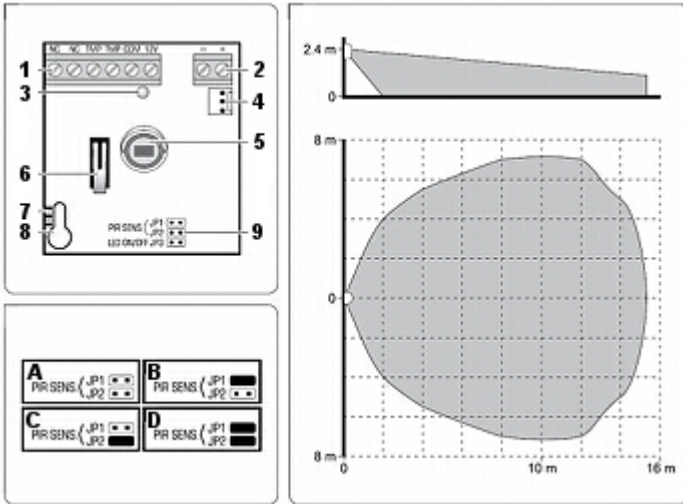

1. cable terminals
2. terminals to connect the lighting control signal
3. LED indicator
4. socket for connection of LEDs to provide lighting feature
5. pyroelectric sensor
6. tamper contact
7. scale for positioning of pyroelectric sensor
8. fixing screw hole
9. configuration jumpers

Proper installation:

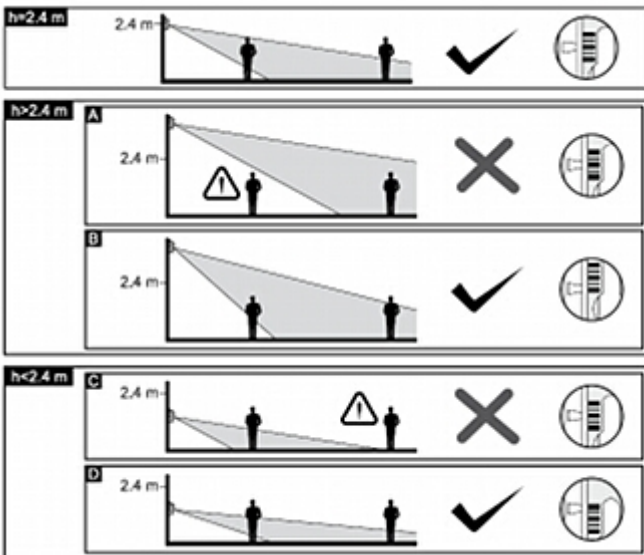

PACKAGE

Dimensions (L x W x H): 0x0x0 mm	Gross Weight: 0 kg
----------------------------------	--------------------